

**SEMAK<sup>®</sup>**

# Vita Juice<sup>™</sup>

OPERATING AND INSTRUCTION MANUAL



**SEMAK<sup>®</sup>**

SEMAK AUSTRALIA PTY LTD

# Contents

03		.....	Parts
04		.....	Important Safeguards
06		.....	Warnings & Cautions
08		.....	Assembling the Units
09		.....	How to Assemble
10		.....	How to Use
11		.....	Warnings & When the screw stops while the machine is in use
12		.....	Disassembling, Cleaning, and Caring for the product
14		.....	The points you have to know before using Vita Juice™
15		.....	Trouble Shooting
16		.....	Specifications
17		.....	Warranty

# Parts

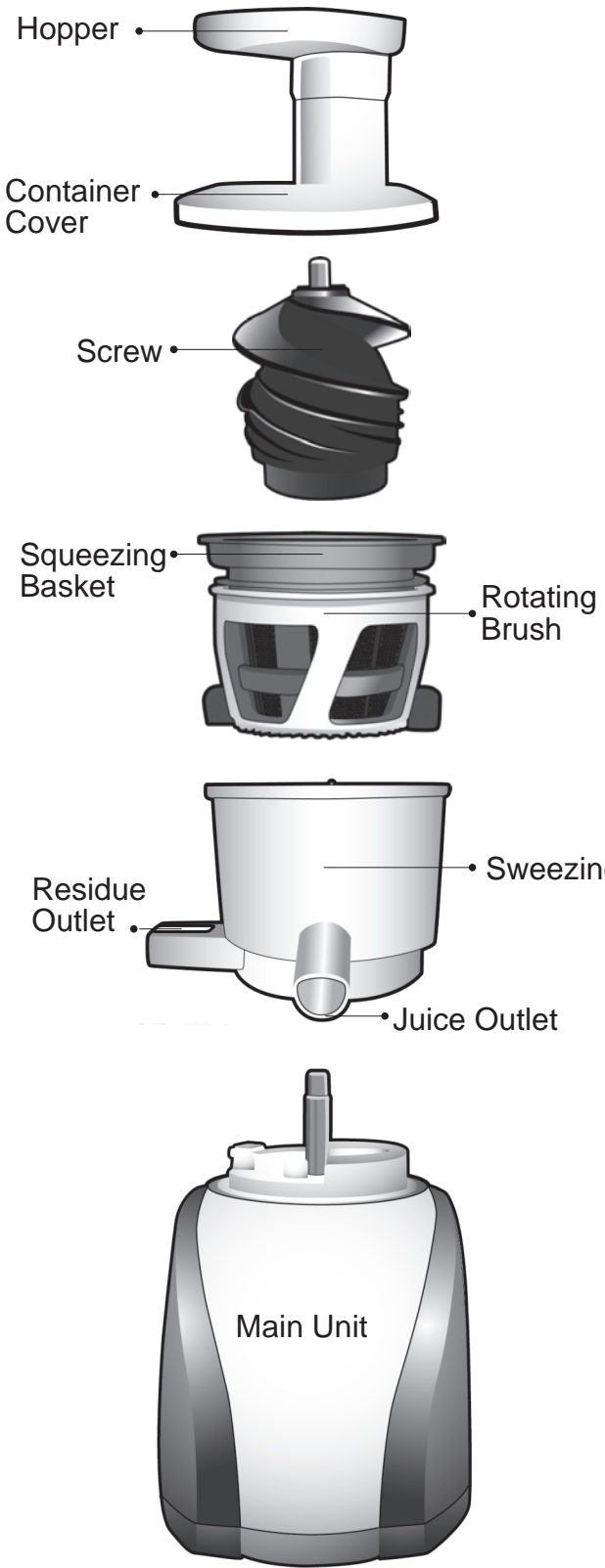

## WARNINGS

Only when the Main Unit and the Container Cover are correctly assembled as in the picture, the inner safety switch and the machine operates.

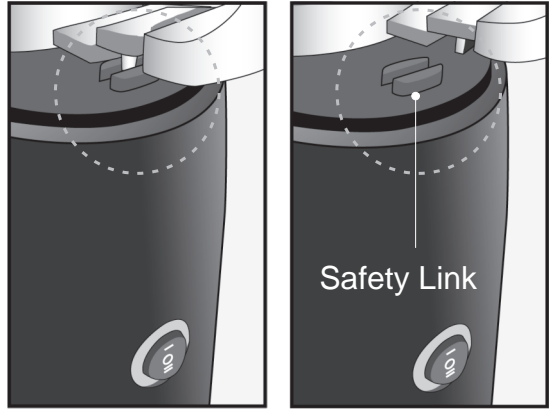

Pusher



Cleaning Brush



Juice Cup



Residue Cup



# IMPORTANT SAFEGUARDS

# Do not let children or Infirm persons use the product without supervision

- Must read and follow this safeguard before using the product for safety issue
- Please follow the instructions for your safety
- Please contact our service representative for any inconvenience or malfunctioning
- Please leave this instruction in a place where anyone can locate this booklet easily

## WARNINGS & CAUTIONS



### WARNINGS

Death and serious injury might occur when not followed



### CAUTIONS

Physical injury or damage on property might occur when not followed

## Index

- Following directions must be followed for your own safety



Prohibition



Do not disassemble



Do not touch



Must be followed



Unplug from outlet



Precautions for electric shock

- Read the instructions
- To protect against electrical shock do not immerse cord, plug, portable appliances in water or other liquid.
- Close supervision is necessary when any appliance is used by or near children or Infirm persons.
- Unplug from outlet when the appliance is not in use, before putting on or taking off parts, and before cleaning. Allow to cool before handling.
- Do not operate any appliance with a damaged cord or plug or after the appliance malfunctions or is dropped or damaged in any manner. Return appliance to the nearest authorized service facility for examination, repair, or electrical or mechanical adjustment.
- The use of accessory attachments not recommended by the appliance manufacturer may cause injuries.
- Do not use outdoors.
- Do not let cords hang over edge of table or counter or touch hot surfaces.
- Do not place on or near hot gas or electric burner or in a heated oven.
- Extreme caution must be used when moving an appliance containing hot oil or other hot liquids.
- Always attach plug to the appliance and check that the control is OFF before plugging cord into wall outlet. To disconnect, turn the control to OFF, then remove plug from wall outlet.
- Do not use appliance for other than intended use.
- Avoid contacting moving parts.
- Always make sure the juice cover is clamped securely in place before motor is turned on.
- Do not unfasten clamps while juicer is in operation.
- Be sure to turn switch to OFF position after each use of your juicer. Make sure the motor stops completely before disassembling.
- Do not put your fingers or other objects into the juicer opening while it is in operation. If food becomes lodged in opening, use food pusher or other piece of fruit or vegetable to push it down. When this method is not possible turn the motor off and disassemble juicer to remove the remaining food.
- Do not use the appliance if the rotating sieve is damaged.
- Do not operate if the pulp container is not in place.
- **SAVE THESE INSTRUCTIONS.**



## IMPORTANTES MESURES DE SÉCURITÉ

- Lisez toutes les instructions.
- Pour éviter les électrocutions, ne plongez pas le cordon, la fiche ou l'appareil portatif (indiquer au besoin d'autres pièces similaires) dans l'eau ou un autre liquide.
- Surveillez bien les enfants s'ils utilisent un appareil ou s'ils se trouvent à proximité d'un appareil en marche.
- (i) Appareils portatifs. Débranchez l'appareil de la prise de courant quand vous ne l'utilisez pas, avant d'enlever ou d'installer des pièces et avant de le nettoyer. Laissez l'appareil refroidir avant de le manipuler.
- Appareils portatifs. Ne faites pas fonctionner l'appareil si le cordon ou la fiche sont endommagés, si l'appareil ne fonctionne pas correctement, s'il est tombé ou s'il a été endommagé. Confiez au service de réparation recommandé le plus proche tout examen, réparation ou réglage électrique ou mécanique de l'appareil.
- L'utilisation d'accessoires non recommandés par le fabricant de l'appareil peut causer des blessures.
- N'utilisez pas l'appareil à l'extérieur (cette consigne peut être omise si le produit est destiné à être utilisé à l'extérieur).
- Ne laissez pas le cordon pendre par-dessus le bord d'une table ou d'un comptoir et assurez-vous que le cordon n'est pas en contact avec des surfaces chaudes.
- Ne placez pas l'appareil près d'un brûleur à gaz allumé ou d'un élément électrique ou tension ou dans un four allumé.
- Soyez très prudent en déplaçant un appareil qui contient de l'huile ou un autre liquide chaud.
- Le cas échéant, branchez toujours la fiche à l'appareil et assurez-vous que l'interrupteur de celui-ci est à la position ARRÊT (OFF) avant de brancher la fiche dans la prise. Pour débrancher l'appareil, placez l'interrupteur à ARRÊT (OFF) puis retirez la fiche de la prise de courant.
- N'utilisez l'appareil que pour la fonction à laquelle il est destiné.
- Évitez de toucher les pièces mobiles.
  
- Veillez toujours à ce que le couvercle du presse-fruits soit fermement et correctement verrouillé avant de mettre le moteur en marche. Ne desserrez pas les fixations lorsque le presse-fruits est en marche.
- Assurez-vous de placer l'interrupteur sur la position OFF ('arrêt') après chaque utilisation du presse-fruits. Assurez-vous que le moteur soit complètement arrêté avant tout démontage.
- N'insérez pas vos doigts ni tout autre objet dans l'ouverture du presse-fruits lorsque ce dernier est en marche. Si de la nourriture se loge dans l'ouverture, utilisez le poussoir ou un autre morceau de fruit ou de légume afin de la pousser vers le bas. Si cette méthode est impossible, éteignez le moteur et démontez le presse-fruits afin de retirer la nourriture gênante.
- N'utilisez pas l'appareil si la passoire rotative est endommagée.
  
- Ne pas fonctionner sans le récipient de la pâte dans le lieu
- **Conservez ces instructions.**



## WARNINGS



Do not disassemble, fix or alter the product, otherwise, fire or electric shock or injury may occur; contact the seller for the repair.



If the supply cord is damaged, it must be replaced by the manufacturer, its service agent or similarly qualified persons in order to avoid a hazard.

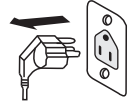

Do not put foreign substance into the crack or hole of the main unit; otherwise, a fire or electric shock or injury may occur.



Do not place fire or pour water near/into the main unit; otherwise, an electric shock or injury may occur.



This appliance is not intended for use by persons (including children) with reduced physical, sensory or mental capabilities, or lack of experience and knowledge, unless they have been given supervision or instruction concerning use of the appliance by a person responsible for their safety. Children should be supervised to ensure that they do not play with the appliance.



While the machine is in use, do not disassemble or insert fingers or foreign objects into the inlet or juice outlet; otherwise, injury or accident may result in.



Do not plug/unplug the machine while hands are wet which might result in electric shock or injury.

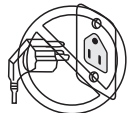

Plug the cord correctly; otherwise, electric shock or fire may occur

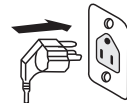

Use only 240V AC, otherwise, electric shock or fire may occur.



Do not bend or tie the cord by force. Do not jerk or place the cord near high temperature. Do not place the cord under a heavy object or plug into narrow place. Do not process the cord arbitrary; otherwise, the cord may be destroyed which may result in electric shock or fire.

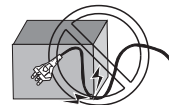

## CAUTIONS



Do not operate the machine while the container cover is not assembled properly; otherwise, injury or accident may result.



Do not operate the machine when there is a gas leak, and ventilate the room properly before putting the power on; otherwise, injury or accident may result in.



# CAUTIONS



This product must be operated on even surface; otherwise, injury or accident may result.



Do not place utensils into the juice outlet under any circumstances; otherwise, injury or accident may result.

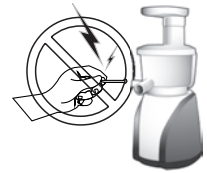

Do not move the machine while operation which may result in a fire, electric shock, or injury. Please contact the distributor for repair.



When the screw stops while the machine is in use, push the reverse rotation button for 2~3 seconds; then push the rotation button. If the status continues, it may overheat the motor resulting in malfunctioning.



Do not assemble or disassemble the parts while in use which may result in injury or malfunctioning. Please assemble or disassemble parts after the machine stops, and unplug the cord from the outlet.



Do not use other than pusher while inserting ingredients into the inlet; otherwise, injury or accident may result.



Do not operate the machine more than 30 minutes consecutively; otherwise, the overheated motor may result in malfunctioning. Please re-operate the machine after 5 minute's pause.



Do not apply excessive impact on the machine or drop it; otherwise, an electric shock, impairment, or fire may occur.



Please unplug the machine when not in use, and do not unplug it by the cord; otherwise, an injury or accident or malfunctioning may result.

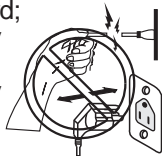

Stop operating the machine when weird noise or excessive heats or smoke is noticed, and contact the distributor or customer center.



This product weights approximately 6.45kg, and one must move it with both hands; you may drop this product by moving it with one hand, and this may result in injury or malfunctioning.



Do not wash this product with water higher than 80°C which may result in malfunctioning or products modification.

# Assembling the Units

1

Assemble the container with the main unit.

Rotate the container clockwise toward safety link.

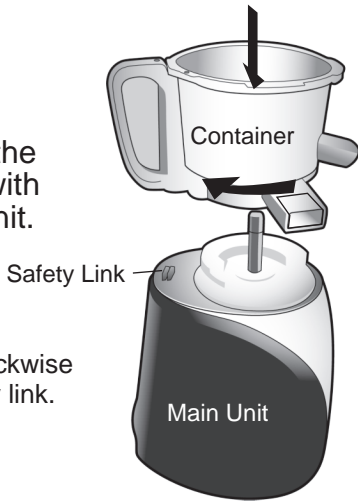

2

Place the squeezing basket into the rotating brush before assembling the rotating brush with the container.

Assemble the container with the rotating brush by mating marks on each of the units as shown on the picture.

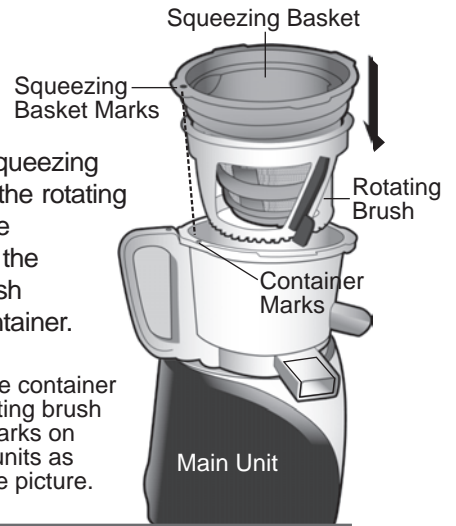

3

Plug the screw into the middle of the squeezing basket.

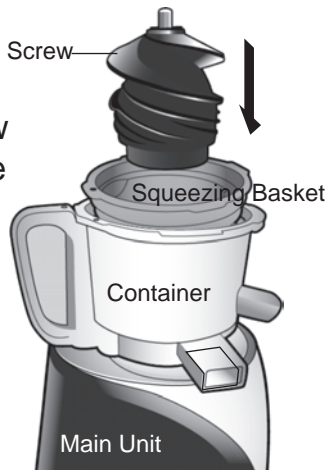

4

Assembling the container cover.

Match the container cover marks with the container marks, and then rotate the container cover towards the container handle marks as shown on the picture.

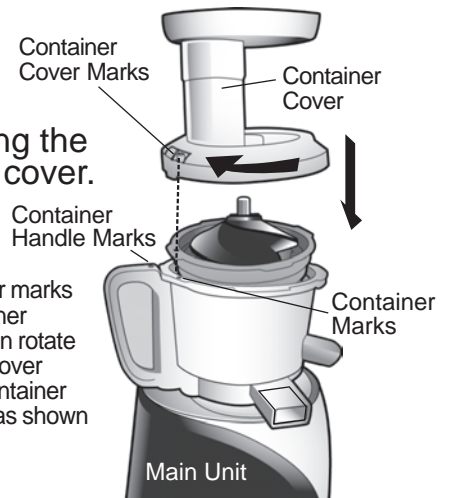

5

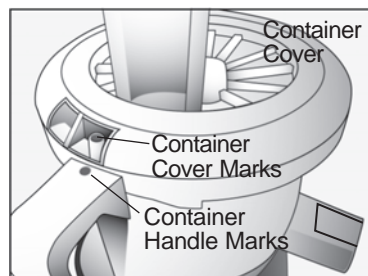
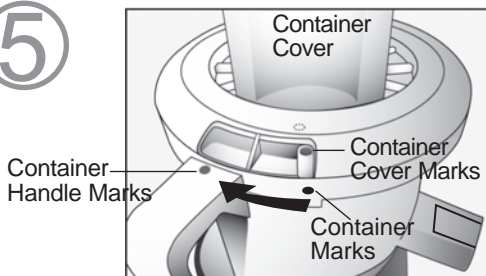

Match the container cover marks with the container marks, and then rotate the container cover towards the container handle marks as shown on the picture.



CAUTIONS

- Assemble the container cover lastly.
- When the container cover is closed, the container and the main unit cannot be assembled.

\*Disassembling of the parts is the reversal of the assembling sequence.



# How to Assemble

## ⑥ How to assemble extraction.

After cleaning the extraction packing after disassembling, link it as the direction shown on the picture before inserting it towards the arrow-marked packing home.

Link Connection



Insertion Direction

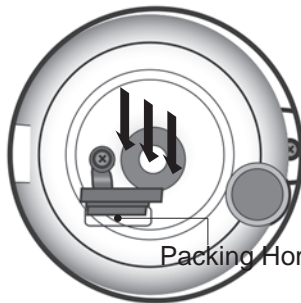

Packing Home

Inserting into Packing Home

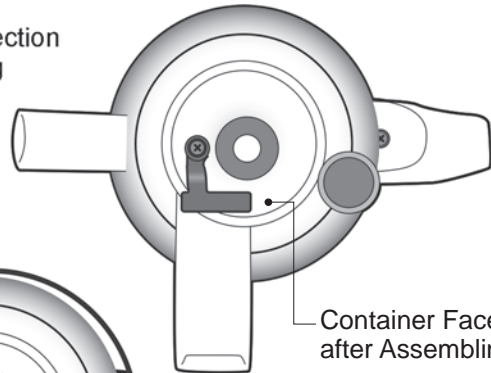

Container Face after Assembling

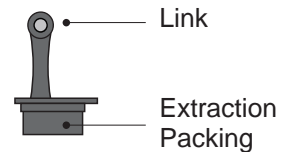

Link

Extraction Packing

## ⑦

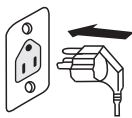

## Plugging into outlet

Plug the cord into the power outlet.

Residue Cup

Juice Cup



## Place the cups

Place both the juice cup and the residue cup as shown on the picture. The both cups look identical.



CAUTIONS

- Assemble the container cover lastly.
- When the container cover is closed, the container and the main unit cannot be assembled.

# How to Use

8

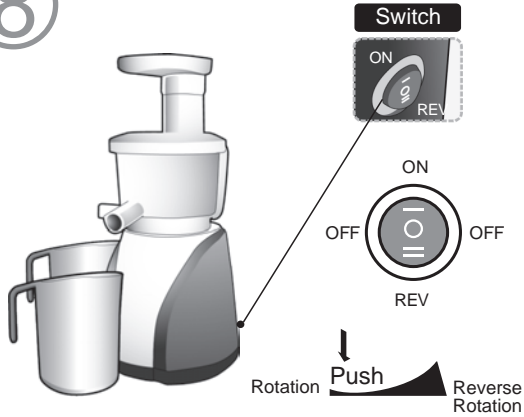

## Push the rotation button Assemble the container cover

Rotation : pushing ingredients towards  
downside extracting juice  
Reverse Rotation : pushing the ingredients  
upwards.



CAUTIONS

Do not operate the machine  
with wet hands; otherwise,  
an electric shock or short circuit  
or fire may occur.

9

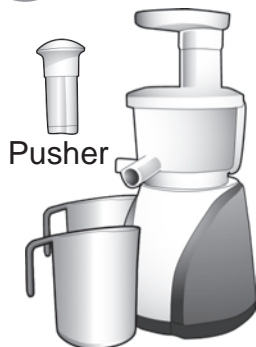

## Insert the clean ingredients into the inlet with pusher.

### Tip

- Be advised that use as fresh ingredients as possible  
for extraction.
- While extracting juices from fruits with hard seeds as  
persimmon or plum, remove the seed before using them.

10

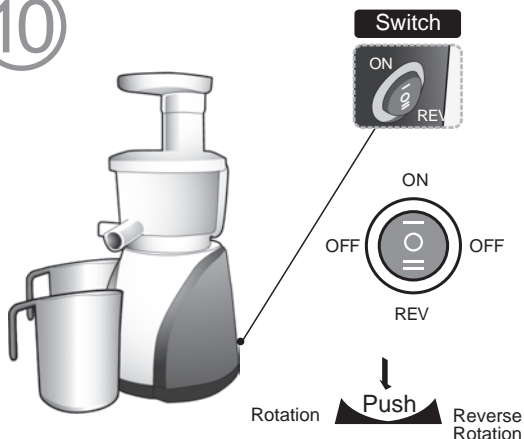

## After the extracting process is done, turn the power off



CAUTIONS

- Do not preserve the extracted  
juices for long time.
- This machine may be used  
for preparing seasonings  
(garlic or pepper), yet do not  
use it for grinding grains. (It  
may result in malfunctioning)
- Do not operate the machine  
with wet hands; otherwise, an  
electric shock or short circuit  
or fire may occur.

# WARNINGS



Do not operate the machine more than 30 minutes consecutively otherwise the overheated motor may result in malfunctioning. Please re-operate the machine after 5 minutes pause.



Do not place utensils or spoons into the juice outlet under any circumstances; Placing foreign objects into juice outlet may result in destruction of parts.



Do not use other than pushing pole while inserting ingredients into the inlet; otherwise, injury or accident may result.



Do not insert grains or fruits with hard seed into the inlet; it may result in destruction or malfunctioning of the container or screw or extraction net  
- While extracting juices from fruits with hard seeds as persimmon or plum, remove the seed before using them.

## When the screw stops while the machine is in use

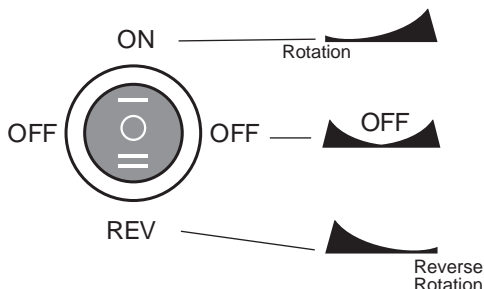

By removing reverse rotation button, the machine stops.

- If the machine stops abruptly while in use, turn off the machine first. Then, push the reverse rotation button in order to remove the ingredients blocking the screws, and push the rotation button. Push the rotation button only after the screws stopped reverse rotation.
- If this process does not work, unplug the machine first and then clean the machine after disassembling the units. Refer to page 11.



CAUTIONS

Do not operate the machine with wet hands; otherwise, an electric shock or short circuit or fire may occur.

# Disassembling, Cleaning, and Caring for Product

1

Stop the machine first, and then unplug the machine

2

Disassemble the container cover first by rotating it toward counter clockwise as the direction ① in the picture, and disassemble the container from the main unit as direction ② in the picture.

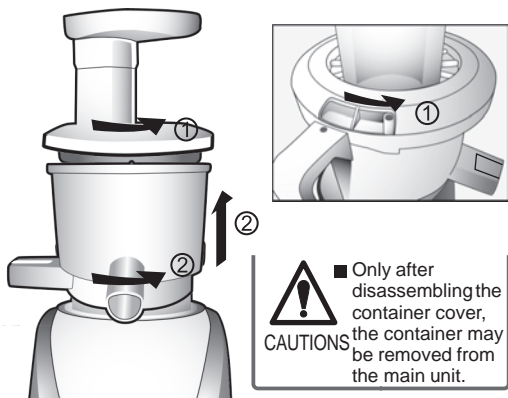

3

Disassemble the parts as the reverse sequence of assembling.

1. Disassemble the container cover by rotating it toward counter clockwise
2. Remove the screw
3. Disassemble the squeezing basket
4. Remove the rotating brush

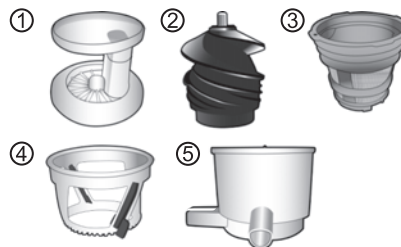

Please be aware that if cleaned right after being used, the residue may lower the performance of the machine or cause difficulties in cleaning.

4

Clean the parts with cleaning brush and running water.



■ Do not use steel brush, abrasive, solvent, or sharp cleaning device while cleaning.

PROHIBITION ■ Do not use automatic dish washer or dish dryer.

5

Do not clean the main unit with running water. Remove the stains only with dried or smooth cloth.



6

After cleaning each part, dry each part completely and place it in a clean place.

★ Optional Products ★ **Chopper Container Assembling the Units**

1

Assemble the chopper container with the main unit.

Rotate the chopper container clockwise toward safety link.

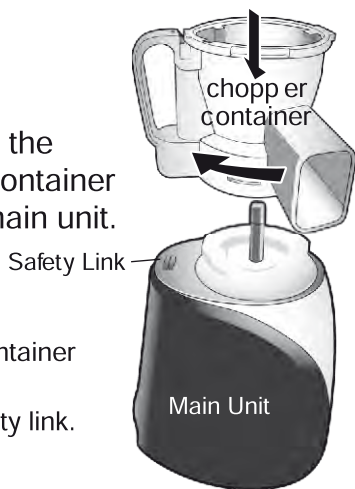

2

Plug the screw into the middle of the Squeezing basket

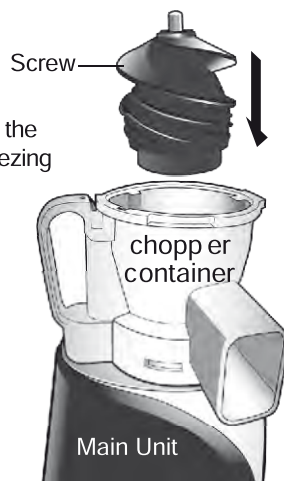

3

Assembling the container cover.

Match the container cover marks with the container marks, and then rotate the container cover towards the container handle marks as shown on the picture.



CAUTIONS

- Assemble the container cover lastly.
- When the container cover is closed, the container and the main unit cannot be assembled.

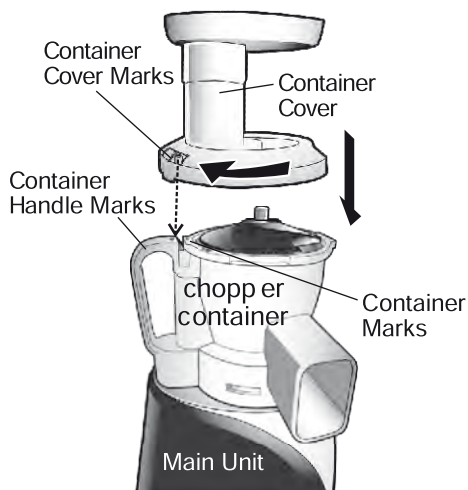

4

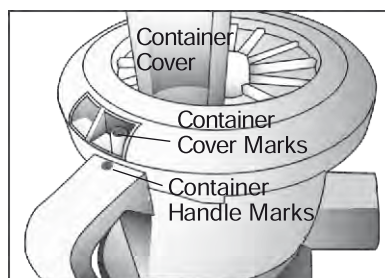
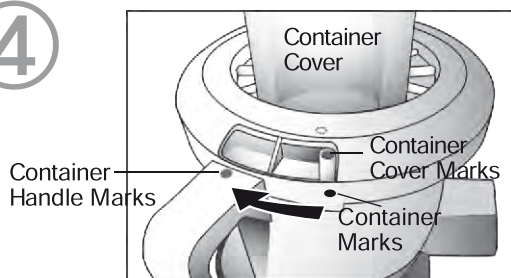

Match the container cover marks with the container marks, and then rotate the container cover towards the container handle marks as shown on the picture.

**Usage for food chopper**

Garlic, ginger, chili, various spices, various sauces and baby food ingredients

★ Disassembling the parts is the reverse of the assembling sequence.

# The points you have to know before using Vita Juice.

## 1. For assembly and disassembly (Order of assembly and disassembly)

- ◆ **Assembly** : Attach the container to the closing direction (Clockwise) of container grip part on the main body. Install the Rotaiting brush →Squeezing Basket →Screw and assemble the lid of the container completely to the closing direction (Clockwise) of container grip part.
- ◆ **Disassembly** : Disassemble the container lid by turning to opening direction (Counterclockwise) and separate the main body and container. Clean it with brush and keep it after complete drying.

Make sure attach according to the assembly order surely because the assembled container set can not be attached on main body.

## 2. How to put the material for operation

- ◆ The material shall be put slowly because Vita Juice juicer revolves 47 times per minute. It is not overloaded and squeezing properly when the hard or sticky fiber is cut into small pieces.
- ◆ The reverse button shall be pressed for 2~5 seconds before disassembly after use and it will be opened when it is disassembled after removing the leftover with normal direction operation.

## 3. In case of stop during operation

- ◆ It can be created by putting large quantity of hard and sticky fiber material comparing to the RPM, or material is jammed in between the screw and juice strainer. Press the stop button and press the reverse button 3~5 seconds and start it again with button for normal direction. (It can be repeated in 2~3 times.)

## 4. When the container lid is not opened after operation

- ◆ See paragraph 3. Press the reverse button 2~3 times and start it in normal direction to remove the leftover food completely and it will be opened smoothly.

## 5. How to prepare the material

- ◆ **Hard vegetables** (Carrot, beat, radish and sweet potato etc.)  
☞ It is proper to cut straight in 2 cm of thickness.
- ◆ **Material of sticky fiber** (Angelica)  
☞ The leaves and stem of angelica shall be divided and the stem shall be cut in 2cm.
- ◆ **How to prepare fruit**  
☞ It is good to cut into many pieces after washing according to the size of input hole and it is good to remove the seeds when they are big and hard (Peach, mango and jujube).
- ◆ **The hard grains** (Bean, red bean and lentil) shall be used after soaking into the water. It will be a reason for overloading or damage on the machine.

# Trouble Shooting

# Before contacting service center, please read the following lists first.

When the machine does not work

Check whether the cord is properly plugged in  
Check whether each part is assembled in proper sequence (please refer to page 8,9)  
Contact customer center

When the extraction process is not properly done and the residue contains much moist.

Check whether the extraction packing is properly inserted (refer to page 9)  
Check whether the ingredients used were fresh  
Place the refrigerated vegetables in the drinking water at least 10 minutes before use

When the machine stops while in use

Check whether the amount of the ingredients were adequate or whether the fruits contained hard seed  
When the screw stops while the machine is in use, push the reverse rotation button for 2~3 seconds; then push the rotation button.  
If this does not work, turn off the machine and cleaning the parts after properly disassembling the machine

If the container is shaking while in use

More or less shaking container while in use is a normal operation, and is not a sign of malfunctioning

Strange noise while in use

Depending on ingredients, noise may be generated in the course of extraction  
This noise may be generated while the ingredients were bumping against each other

When the container cover is not disassembled easily

Grab the lower part of the hopper firmly and rotate it towards counter clockwise with force

# Service & Maintenance

For Service and Repair, contact Semak for your nearest Authorised Service Agent

The Foodservice Industry is deemed a hostile environment within the scope of AS/NZS 3760:2003. Semak Juicer MUST be routinely electrically tested for compliance with this standard if used commercially.



It is recommended that a Food Safety program such as HACCP be employed and that routine service and repair be undertaken at the time of electrical testing to ensure the correct operation and function of all parts.

## Electrical Specifications

Product Name	Semak VitaJuice Model VJ2012
Dimensions	Length 280mm
	Width 540mm
	Height 310mm
Voltage	240V / 50 HZ
Wattage	200W
Motor	Single Phase 10 amp
RPM	47
Certification	CE, ISO9001

## Electrical Compliance

Semak Vitafruit complies with:

-  IEC 60335-2-14:2011 Electrical Safety
-  CISPR14-1:2000 Electromagnetic Compatibility

## Warranty

The Semak VitaJuice VJ2012 is a domestic appliance which may be used for light commercial use in some circumstances. This product is guaranteed for 10 Years from the date of purchase against mechanical and electrical defects. If the fault is deemed caused by MISUSE/ABUSE the terms of the warranty are invalidated. If the product has been opened or tampered with (ie. In an attempt to repair it) the warranty is invalidated. All warranty repairs should be undertaken by Dimark Commercial Pty. Ltd.

It is against company policy to authorize warranty repairs over the phone. Service Agents will require a work order number from Semak to conduct warranty repairs.



# Warranty

## SEMAK® WARRANTY

### **THIS WARRANTY APPLIES ONLY TO PRODUCTS MANUFACTURED AND SOLD IN AUSTRALIA**

The benefits conferred by this warranty are an alternative to all other rights and remedies in respect of the product which the consumer has under the Trade Practices Act and similar State and Territory Laws.

Semak Australia. Warrant each new SEMAK appliance manufactured by SEMAK to be free from defects in materials or manufacturing process for a period of 10 years from the date of original purchase.

Should defects due to faulty materials or manufacturing process develop within the warranty period. The warranty covers the repair of the appliance or replacement of any defective part, insofar as the defect is the fault of the manufacturer and is not due to misuse or incorrect operation.

1. Proof of Purchase and Warranty card must be retained and available on request.
2. This Warranty is void if the equipment has been damaged due to misuses neglect or is used for a purpose for which it was not suited; and no repairs, alterations or modifications have been attempted by other than Semak or its authorised Service Agent.
3. Semak Australia. Reserves the right to reject a claim for warranty if service is required due to misapplication, improper installation, inadequate wiring, and incorrect voltage conditions. Under no circumstances shall SEMAK or its agents bear responsibility for consequential damages of any kind.
4. Where required by Statute or local authority, equipment must be installed by qualified person in accordance with all relevant regulations. Failure to do this will void product warranty.
5. Cost of transport of any appliance or part to and from SEMAK or its Service Agent is to be paid by the owner.
6. A charge will be made where failure is due to neglect, abuse or accidental damage on the part of the operator, or when no fault can be found or the fault is due to causes outside the control of Semak Australia.
7. The above does not preclude the purchaser from their Statutory rights as a consumer.

### **Semak Australia**

Factory 18

87-91 Hallam South Road

HALLAM VIC 3803

Ph 61 3 9796 4583

Fax 613 9796 4586

Email [technical@semak.com.au](mailto:technical@semak.com.au)

# Warranty Registration

Retain for Future Reference

DO NOT SEND

Please complete one registration for each Semak appliance.

You may be required to provide this information when requesting after sales service. Please staple your proof of purchase to this page.

Company Name: \_\_\_\_\_

Company Address: \_\_\_\_\_

Business Type: \_\_\_\_\_

Contact: \_\_\_\_\_

Phone: \_\_\_\_\_

Fax: \_\_\_\_\_

Email: \_\_\_\_\_

Product: \_\_\_\_\_

Serial Number: \_\_\_\_\_

Date of Purchase: \_\_\_\_\_

Place of Purchase: \_\_\_\_\_

# NOTES

**SEMAK<sup>®</sup>**

*Vita Juice<sup>™</sup>*

[www.semak.com.au](http://www.semak.com.au)

**Semak Australia**

18 /87-91A Hallam South Road, Hallam Vic 3803

Telephone: +61 3 9796 4583

Facsimile: +61 3 9796 45836

Email: [sales@semak.com.au](mailto:sales@semak.com.au)

Hours: Monday to Friday 9 am - 5 pm