



ZUMEX MULTIFRUIT

Fig. 1

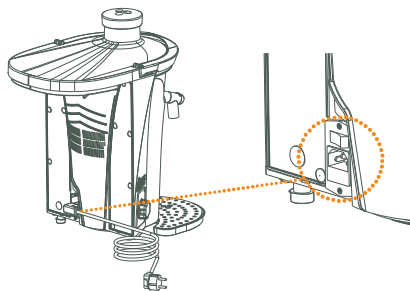

Fig. 2

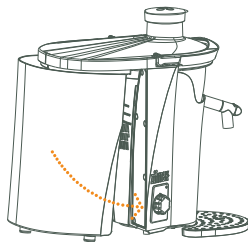

Fig. 3

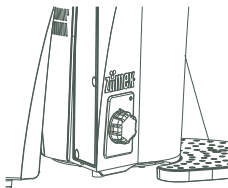

Fig. 4

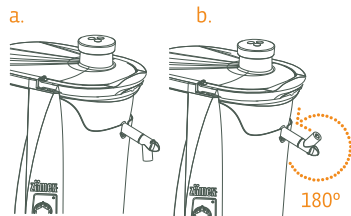

Fig. 5

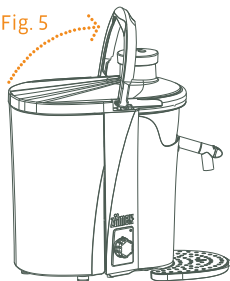



Fig. 6

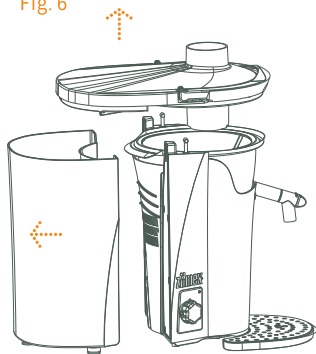

Fig. 7

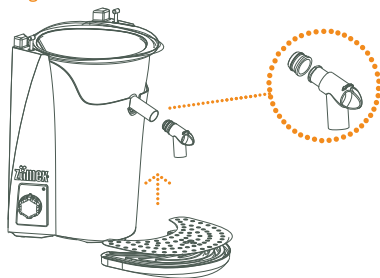
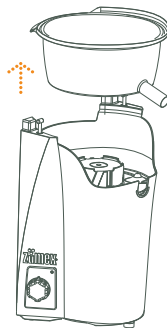
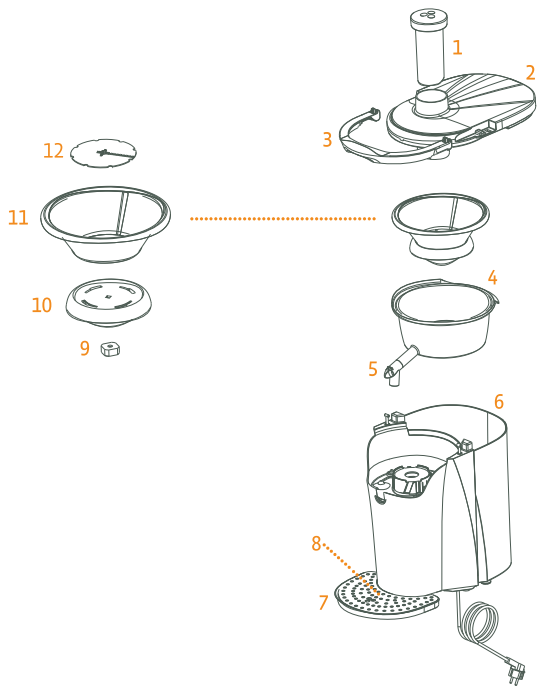

Fig. 8



Diagrams with parts



Electrical Diagram CE

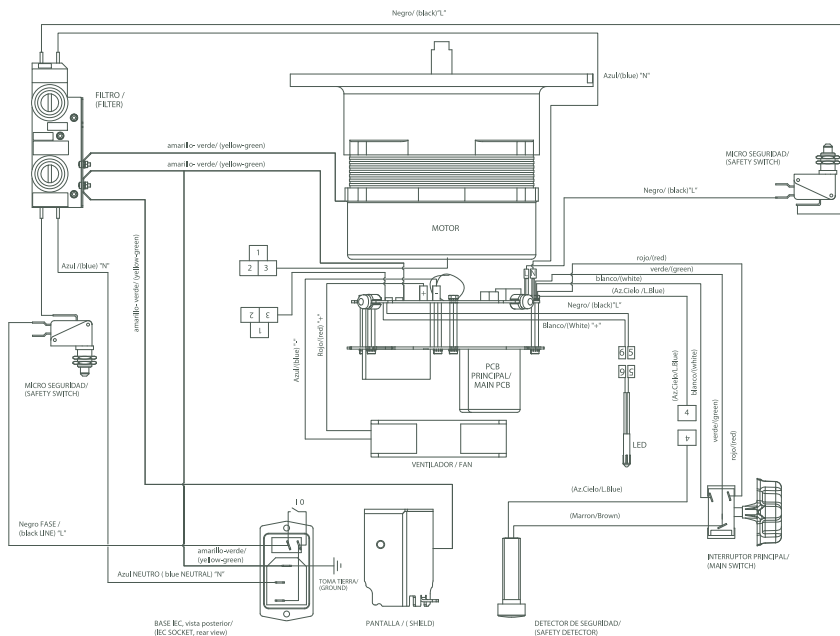

Electrical Diagram UL

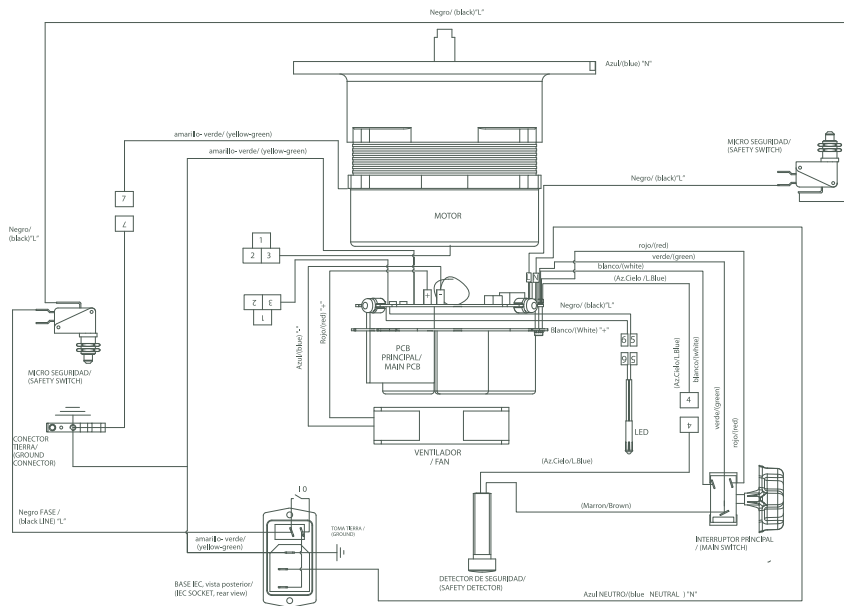

A stylized world map rendered in a light gray, dotted or pixelated texture. The map shows the continents of North America, South America, Europe, Africa, Asia, and Australia. The text "All around the World" is centered over the map.

All around the World

www.zumex.com

**Congratulations, you have purchased
the most efficient juicer of its kind.**



INDEX

- 2 Figures
- 5 Electrical Diagram
- 23 General Information
- 24 Technical Characteristics
- 25 Warranty and Certifications
- 26 Instructions for use
 - 26 General Description
 - 26 Preparation
 - 27 Operation
 - 28 Cleaning
- 30 Detecting faults and problems
- 31 EC Declaration of conformity

General Information

This manual describes the general information for the following Zumex model:

ZUMEX MULTIFRUIT

The specific data of your Zumex juice extractor (voltage, frequency and other important data) are located on the ID Label, found on the unit.

Contact your Distributor / Official Technical Support Service for any technical questions you might have, providing the Serial Number shown on the ID Label of the unit.

Disconnect the unit before carrying out any cleaning or maintenance procedures, disconnect the machine from the power supply by using the rear switch or by unplugging the cable.

Zumex adopts all measures required to collect units that are not in operation, guaranteeing the correct environmental management practices. Please, contact your Zumex authorized distributor to discard these units.

This unit has not been designed for its use by persons (including children) with a reduced physical, sensorial or mental capacity, or who do not have enough experience or understand how the unit operates. However, said persons can use the machine under the supervision of qualified persons or if they follow the instructions of a person who is responsible for their safety.

Zumex will address all comments and suggestions you might have about our units or service network. Please contact directly at this address:

ZUMEX GROUP, S.A.
Polígono Ind. Moncada III · C/ Molí, 2
46113 · Moncada · Valencia · España
Tel.: +34 961 301 251 · Fax: +34 961 301 255
www.zumex.com · zumex@zumex.com

Technical Characteristics

ZUMEX MULTIFRUIT	
Speed:	3500 · 4500 r.p.m.
Dimensions (cm · inches):	51,3 x 49,3 x 29,3 cm · 20" x 12" x 20"
Net weight (kg. · lb):	15 Kg. · 33.07 lb
Nominal power:	700W - 870W.
Protection:	IPX2
Acoustic pressure level:	Lower than 70dB (A).
Safety:	Double safety microswitch Thermal protection.
Maximum fruit size:	75 mm.

Warranty and Certifications

Scope of the warranty The unit has a two-year warranty against defects and construction problems that could harm the correct operation, provided that the inner parts or mechanisms have not been manipulated. The following are excluded from the warranty.

Exclusions Labor, trips, transport, parts that have become deteriorated due to natural wear as a consequence of use, as well as any damage resulting from the incorrect usage or installation of the unit and faults caused as a result of force majeure.

Any incorrect handling of the ID Label will make the Warranty void. Likewise, the warranty will also be void if other persons handle the unit, since only the Official Technical Support Service is qualified and authorized to do so.

Always provide the SERIAL Nr. on the ID Label when contacting the Technical Support Service.



* Certifications vary according to the model, please check the machine's Identification Label.

Instructions for use

General description

- | | |
|------------------------|--------------------------------|
| 1 Pusher | 7 Coaster |
| 2 Cover | 8 Coaster Stainless steel Trim |
| 3 Locking Handle | 9 Grating Disk |
| 4 Stainless Steel Tank | 10 Filter |
| 5 Anti-drip Tap | 11 Filter Driver |
| 6 Peel Bucket | 12 Filter Driver Nut |

Preparation

Setting up the juice extractor:

STEP 1 Remove the packaging and place the juice extractor on a flat surface.

STEP 2 Connect the supplied cord to the appliance and plug into a standardised earthed socket. Fig.1.

STEP 3 Place the peel bucket as shown in Fig.2. (To keep the peel bucket from getting dirty, you can line it with a bin bag, leaving the top of the bag hanging over the edges of the container.)

STEP 4 Check that all parts affected by the safety cut-offs (stainless steel tank, peel bucket, and cover locking handle) are correctly positioned otherwise the safety cut-offs will stop the appliance from working.

REMEMBER Given that the diameter of the fruit feeding tube is 75 mm, larger fruits should be cut up into smaller pieces. When the pieces of fruit are smaller than the conduct's diameter, you may process several together.

Operation

Preparing the fruit and vegetables

- Always wash fruit and vegetables before processing them.
- Peel fruits with inedible or thick skins, such as pineapple, melons, mangoes or kiwis, before juicing.
- Stone large-stoned fruits, such as peaches, plums or cherries, before juicing.
- Given that the diameter of the fruit feeding tube is 75mm., larger fruits should be cut up into smaller pieces. When the pieces of fruit are smaller than the feeding tube's diameter, you may process several together.

Operation

Step 1: Switch the machine on by putting the rear power switch on 'I'. Place the waste bucket in the correct position, next to the rear of the machine. You will immediately observe that the LED next to the selector lights on, showing that the machine is ready to juice. If you see that the indicator light is flashing, please make sure that the waste bucket is placed correctly. If the flashing continues, please get in contact with Technical Support.

Step 2: Place a container under the juice outlet and select the required speed (• or ••). In order to get the highest performance, the speed • is the one for soft fruit (e.g. apples, pineapples, watermelon, strawberries, grapes). The speed •• is perfect for hard fruit or vegetables such as carrots, broccoli, celery, beetroot, etc. Once you have selected the speed, the machine will start to operate and the LED will stay on.

Step 3: Insert the fruit in the tube and press it with the pusher. You'll get juice instantly.

Step 4: To stop the machine, turn the switch to the position Standby. Remember that the machine will remain on Standby until the rear power switch is 'O' position.

Step 5: To prevent the juice from dripping when not blending, activate the anti-drip tap by turning it 180° (fig. 4).

NOTE: After the machine remains on Standby for a long time, the internal cooling fan may start up and will make a quiet noise. This operation is completely normal.

Safety cut-offs

⚠ If the locking handle is lifted or the peel bucket removed during operation, the machine will automatically stop. The machine will also not work if the cover and locking handle are assembled without fitting the stainless steel tank. If there is a power cut whilst the appliance is running, it will not automatically start up again once the power comes back on. To start up the machine, put the selector and the rear power switch on the “o” position. After re-connecting it or restoring the electrical power supply, you must start up the switching on process, retuning to step 1.

⚠ To avoid accidents do not manipulate the machine in order to make it work without the security devices (handle, cover and peel bucket).

ATTENTION Whenever there is an emergency stop, once the problem is solved, you must put the speed selector on “o” and then select the required speed.

Cleaning

The following are the steps for correctly cleaning the juice extractor:

STEP 1 Put the rear switch on “o” and disconnect the machine from the power supply, by pulling the plug (do not pull the cable).

STEP 2 Remove the handle lifting it up from the front. (Fig. 5).

STEP 3 Remove the cover lifting it upwards and separate it from the peel bucket. (Fig. 6).

STEP 4 Dismantle the anti-drip tap and coaster. (Fig. 7).

STEP 5 Dismantle the grater-filter and the stainless steel tank assembly, by pulling the bucket upwards, following which they should come apart easily. (Fig. 8).

ATTENTION Handle the grater-filter assembly carefully. Do not touch the sharp points of the grater as they could cut you.

- All these components are dishwasher safe. If pulp has dried on any component, we recommend you soak it in water and soap suitable for tableware until the pulp softens, after which it can be washed in the dishwasher.
- Clean the outside of the appliance (motor housing) and the rubber areas that support the stainless steel tank, using a soft cloth soaked in water and soap suitable for tableware.
- Afterwards, rinse with a damp cloth and clean water to remove all traces of soap.
- When putting the grater-filter back, make sure it is correctly mounted, pushing it down firmly as far as it will go.
- It is recommended to take apart the grating disk from the filter for an in depth cleaning procedure. To assemble, we recommend tightening the nut firmly help if needed with a spanner.

ATTENTION To avoid dry pulp accumulating between uses, thus making cleaning more complicated, pour a jug of water through the fruit input opening with the appliance still running. This procedure can also be used to prevent flavours mixing when processing different fruits.

Detecting Faults and problems

PROBLEM: The machine is not working. LED OFF.

Possible cause

The machine is unplugged
No power reaches the plug
The cover is not placed correctly
The handle is not placed correctly
The fuse has blown

Corrective measure

Connect the machine to the power supply.
Check the plug.
Make sure that it is placed correctly.
Make sure that it is placed correctly.
Replace (the machine includes a spare one next to the first one). Figure 1 detail.
Please contact Technical Support.

PROBLEM: The machine doesn't work the LED is flashing

Possible cause

The waste bucket is separated from the machine body

Corrective measure

Put the waste bucket next to the machine, in the correct position.
Please contact Technical Support.

PROBLEM: The machine works but the LED is off

Possible cause

Anomaly inside the machine

Corrective measure

Please contact Technical Support.

PROBLEM: The machine often gets blocked when juicing

Possible cause

Not enough voltage

Corrective measure

Check that the voltage is the one stated in the manual.

PROBLEM: The machine vibrates a lot when juicing

Possible cause

Unbalanced filter because of the fruit

Corrective measure

Disassemble the filter and clean it.

PROBLEM: : The juice has too much pulp

Possible cause

The cover is full of waste

Corrective measure

Disassemble the cover and clean it.

Blending soft fruit on speed••

*Use speed•for soft fruit and speed••
for hard fruit*

PROBLEM: : The anti-drip outlet gets obstructed

Possible cause

The juice has pips or too much pulp

Corrective measure

*Remove the anti-drip and clean it.
Use speed•for soft fruit and speed••
for hard fruit*

IMPORTANT Always unplug the appliance from the power supply before carrying out any operations to unblock it or remove any obstructions. If, after following the troubleshooting advice contained in this manual, the appliance still does not work, contact the Technical Support Service.

EC Declaration of conformity



We, **ZUMEX GROUP S.A.** at Polígono Ind. Moncada III, C/ Molí - 2 - 46113, Moncada - Valencia - Spain declare under our sole responsibility that the Blender

ZUMEX MULTIFRUIT

machine conforms to the following health safety standards:

EN ISO 12100-1 2003	Safety of machinery. Basic concepts, general principles for design. Part 1: Basic terminology, methodology.
EN ISO 12100-2 2003	Safety of machinery Basic concepts, general principles for design. Part 2: Technical principles.
EN 60335-1 2002	Household and similar electrical appliances. Part 1: General requirements.
EN 60335-2-14 2006	Household and similar electrical appliances. Part 2-14: Particular requirements for kitchen machines.
EN 62233 2008	Measurement methods for electromagnetic fields of household appliances and similar apparatus with regard to human exposure.
EN 55014-1 2006	Electromagnetic compatibility. Requirements for household appliances, electric tools and similar apparatus. Part 1: Emission.
EN 55014-2 1997	Electromagnetic compatibility. Requirements for household appliances, electric tools and similar apparatus. Part 2: Immunity. Product family standard.
EN 61000-3-2 2006	Electromagnetic compatibility. Part 3: Limits - Section 2: Limits for harmonic current emissions (equipment input current up to and including 16A per phase).

EN 61000-3-3 1995	Electromagnetic compatibility. Part 3: Limits - Section 3: Limitation of voltage changes, voltage fluctuations and flicker in public low-voltage supply systems, for equipment with rated current 16A.
EN 1672-2 2005	Food processing machinery. Basic concepts. Part 2: Hygiene requirements.
Reglamento (CE) Nº 1275/2008 2008	With regard to ecodesign requirements for standby and off mode electric power consumption of electrical and electronic household and office equipment

Complying with the provisions in the European Directives listed below:

2006/42/CE	Safety of machinery.
2006/95/CE	Directive on the harmonisation of the laws of Member States relating to Electrical Equipment designed for use within certain voltage limits.
2004/108/CE	Directive on the approximation of the Laws of Member States relating to electromagnetic compatibility.
2002/72/CE	Directive on good manufacturing practice for materials and articles intended to come into contact with food.
2002/95/CE	Directive on the restriction of the use of certain hazardous substances in electrical and electronic equipment (RoHS).
2002/96/CE	Directive on waste electrical and electronic equipment. (WEEE)
2005/32/CE	Directive establishing a framework for the setting of ecodesign requirements for energy-using products.

Moncada, 10th June 2011