

specifications

PG550HCr-2

SKOPE Gen2 Pegasus Horizontal 1/1
REMOTE 4 Door Chiller (JH3304)

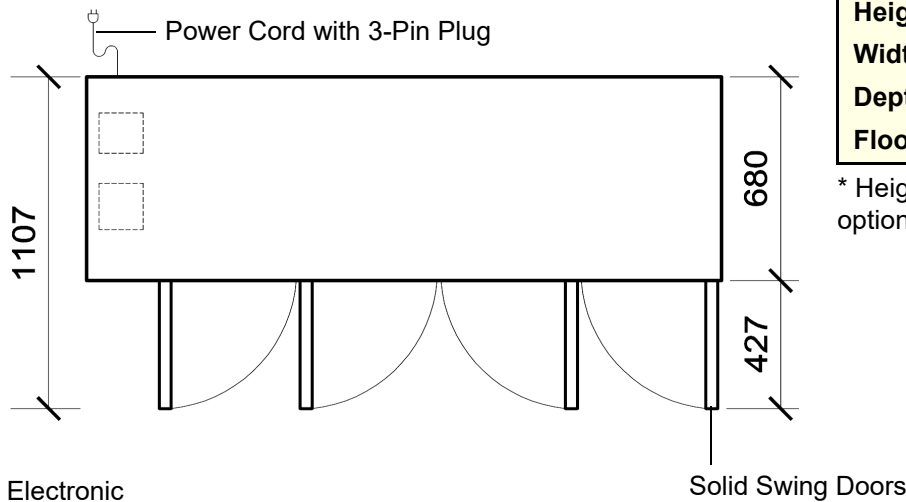

	External	Internal
Height:	716mm*	570mm
Width:	2117mm	1769mm
Depth:	680mm	545mm
Floor area:	1.44m ²	

* Height excludes castors, legs or optional worktop.

Electronic Controller

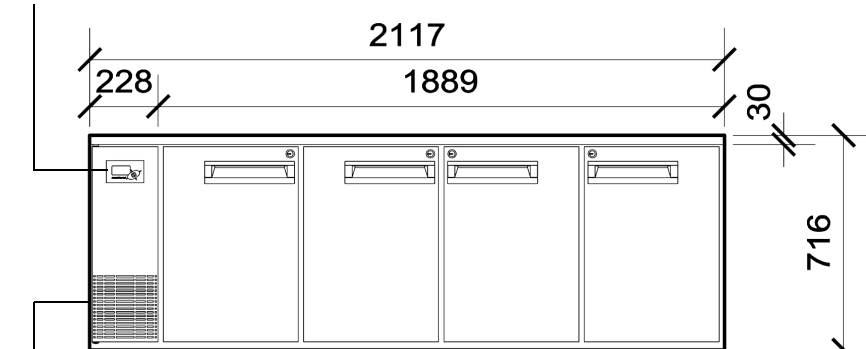

Evaporator box and service compartment

Dimensional tolerances	
Before installing this cabinet allow the following dimensional tolerances:	
Linear dimensions	Overall cabinet dimensions
Less than 1 metre	±5mm
More than 1 metre	-5mm to +10mm
Length of multiple cabinets	
At each joint	At each end wall
±5mm	+15mm
-5mm to +10mm	+15mm

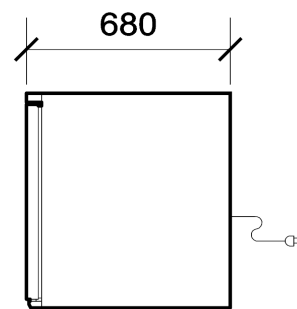

Copyright © 2008 SKOPE Industries Limited

CABINET SPECIFICATIONS

Refrigeration system:	Electronic controlled, side mounted, remote refrigeration unit
Refrigerant:	Thermostatic expansion valve fitted to suit R134a/R404A/R452A
Pipe connection size:	Liquid line: 1/4". Suction line: 3/8"
Remote refrigeration duty:	630 Watts
Cabinet internal volume:	560 litres
Insulation:	60mm thick, high density cyclo-isopentane polyurethane foam
Cabinet temperature range:	+1°C to +4°C up to 43°C ambient
Drainage:	Evaporator drain fitted inside service compartment (requires plumbing)
Electrical:	230-240 Volts a.c. 50 Hz, 0.69 Amps
Internal lighting:	2 x 5W T8 LED tubes (Ø26 x 360mm) - Door activated
Internal door opening size:	4 door openings: 570mm high x 365mm wide
Doors:	Solid stainless steel, self-closing doors (with key lock) - LH & RH hinged
Worktop (optional):	Optional 35mm stainless steel worktop with 65mm square edged fascia
Shelves:	Two levels of non-tip, adjustable tray slides and/or shelves per door
Weight:	145 kg

SKOPE Industries Limited reserve the right to alter specifications without notice.

PSS0182 Rev 2.2 Nov. 2019



SKOPE INDUSTRIES LIMITED



New Zealand Freephone: 0800 947 5673, Fax: (03) 983 3896. Australian Freephone: 1800 121 535, Freefax: 1800 121 533

Email: enquiry@skope.co.nz Website: www.skope.co.nz