

## Hot Food Displays - Straight Glass

### W.HFS.xx



Shown with optional trolley.

#### Product Information:

- Air insulated tank with double skin stainless steel construction
- All units complete with rear sliding doors on rollers for council compliance
- In-tank temperature probes for accurate measurement and lower running costs
- Multiple element design for reliable operation and even temperature
- Improved infra-red heat lamp configuration for optimum heat & light
- Toughened glass on all sides for maximum safety
- Rectangular base to easily drop in to bench cut-out
- Optimum visibility of product - no unsightly corner post to front
- Mechanical thermostat control with temperature gauge
- Designed to run between 70°C - 80°C
- Takes gastronorm pans up to 100mm deep (sold separately)
- Other pan sizes and combinations available
- Available in a range of sizes from 2-6 modules
- Available in a variety of other profiles, with matching cold food displays
- Wide range of functional accessories available
- **12 months on-site parts and labour warranty**

#### Note:

- Not recommended for the display of chickens or roast meats
- All Woodson units are designed for use with Woodson pans. Other suppliers pans may fit, however this is not guaranteed.

#### Specifications:

Model	W.HFS22	W.HFS23	W.HFS24	W.HFS25	W.HFS26
Height	725mm	725mm	725mm	725mm	725mm
Width	705mm	1030mm	1355mm	1680mm	2005mm
Depth	600mm	600mm	600mm	600mm	600mm
Power	1.5kW 10A plug & lead fitted	2.4kW 10A plug & lead fitted	3.0kW 15A plug & lead fitted	3.3kW 15A plug & lead fitted	3.6kW 15A plug & lead fitted

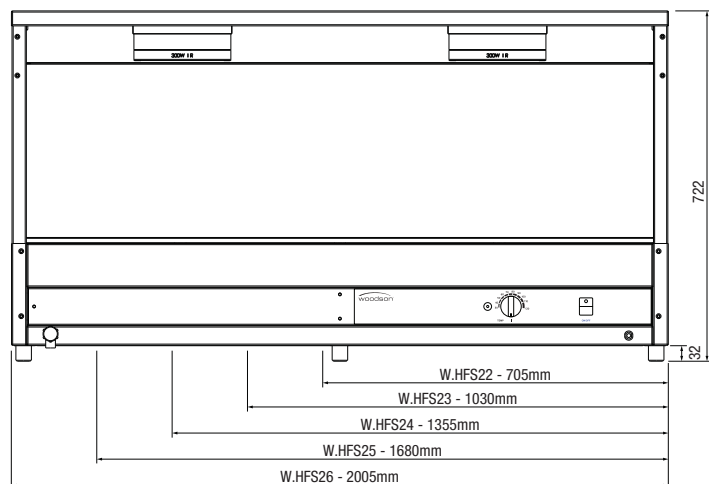
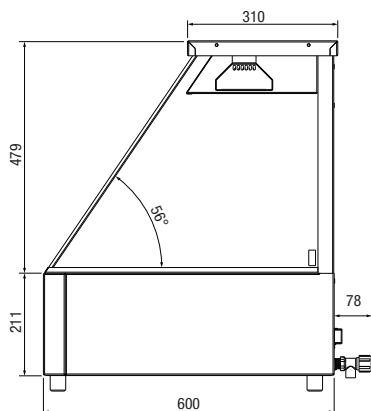

Due to continuous product research and development, the information contained herein is subject to change without notice.

Revision: 24/06/2020

[www.stoddart.com.au](http://www.stoddart.com.au)

[www.stoddart.co.nz](http://www.stoddart.co.nz)